



## SHRIRAM PISTONS & RINGS LTD.

MD:TS:31/MAR'24 INTRODUCTION CIRCULAR—**MARUTI SWIFT/ DZIRE (2020 onwards)**—**PISTON SET**

USHA is pleased to launch **Maruti Swift/ DZire (2020 onwards)** piston set in its Car aftermarket product range.

This piston set is compatible for **Maruti Baleno, WagonR, Fronx, EECO 1.2L BS-VI** models.



This piston set has following special features:

### PISTON:

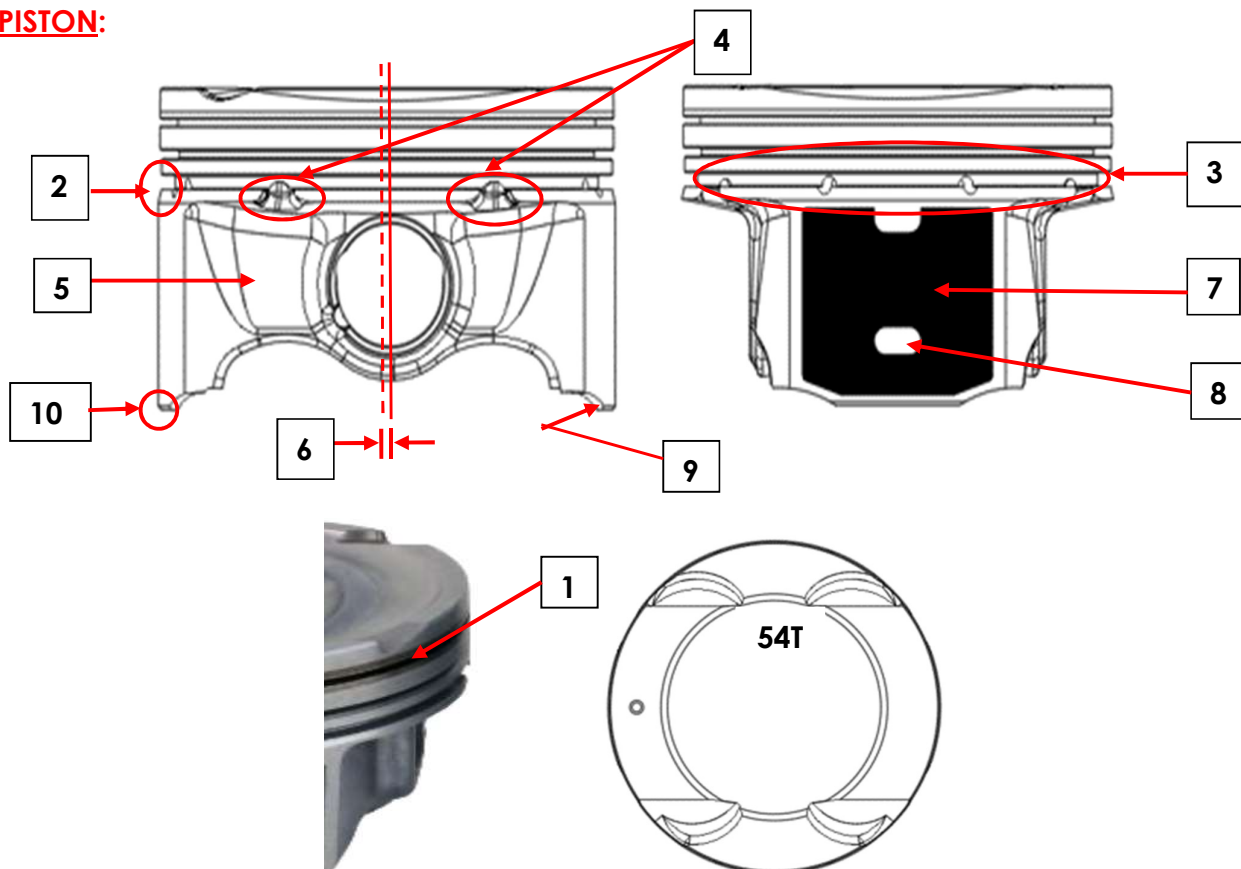

Unique features of this piston are as follows: -

SL. NO.	SPECIAL FEATURE	BENEFITS TO CUSTOMER
1)	<b>ANODISING AT 1<sup>ST</sup> RING GROOVE:</b> Top ring groove is hard anodized to avoid micro-welding of ring inside the groove at elevated engine temperature.	<ul style="list-style-type: none"> <li>• Withstand higher temperatures and thereby reduces chances of ring sticking</li> <li>• Minimises ring groove wear, hence longer life</li> </ul>
2)	<b>CHAMFER AT BOTTOM OF OIL RING GROOVE:</b> This piston has an all-round chamfer just below the oil ring groove area.	<ul style="list-style-type: none"> <li>• Provides all time lubrication to piston skirt</li> <li>• No piston seizure in extreme limits of normal working conditions</li> </ul>
3)	<b>HOLES IN OIL RING GROOVE AREA:</b> 04 nos. of holes are provided on either side of piston, half in groove & half in window.	<ul style="list-style-type: none"> <li>• Faster drainage of excess oil</li> <li>• Reduced oil consumption</li> </ul>
4)	<b>QUICK OIL RETURN SLOTS (QORS):</b> Two nos. of Quick Oil Return Slots (QORS) are provided on either side of piston above the pin bore, half in groove & half in window.	<ul style="list-style-type: none"> <li>• Quick drainage of oil, hence low oil consumption</li> </ul>
5)	<b>AS CAST RELIEF IN PIN BORE AREA:</b> As cast relief in pin bore area not only helps in faster drainage of oil towards sump but also in avoiding chances of seizure on minor axis.	<ul style="list-style-type: none"> <li>• Low oil consumption</li> <li>• Longer life</li> </ul>
6)	<b>PISTON - PIN BORE OFFSET:</b> Piston pin bore offset is provided to avoid piston slap. Piston pin bore offset means that the centre line of piston is slightly offset from the centre line of pin bore. Due to this offset, piston tilts at TDC & BDC smoothly, that prevents slapping with liner.	<ul style="list-style-type: none"> <li>• Reduced engine noise</li> <li>• Lesser wear</li> </ul>
7)	<b>'NANO-friKS COATING' ON PISTON SKIRT:</b>	<ul style="list-style-type: none"> <li>• Helps in initial lubrication &amp; seizure free operation</li> <li>• Better wear resistance</li> <li>• Reduces engine noise</li> </ul>
8)	<b>MEASURING POINTS ON PISTON SKIRT:</b>	<ul style="list-style-type: none"> <li>• Provided for easy diameter verification</li> </ul>
9)	<b>SLIPPER DESIGN:</b> Slipper design helps in reducing piston weight.	<ul style="list-style-type: none"> <li>• Improves fuel efficiency</li> <li>• Low noise during engine working</li> </ul>
10)	<b>SCRAPPING CHAMFER:</b> A smooth chamfer is provided at the bottom end of the piston skirt.	<ul style="list-style-type: none"> <li>• Helps in regulating oil supply, reduces skirt wear &amp; hence longer life</li> </ul>

**TECHNICAL DATA – ‘MARUTI SWIFT/DZIRE’ (2020 onwards) PISTON****USHA CODE → C32**

Nominal Bore Diameter	mm	73.00
Piston Diameter	STD Size mm	72.977
Recommended Piston-Liner Clearance	mm	0.023
Compression Height	mm	27.30
Total Height	mm	44.55
Piston Pin length X diameter	mm	44.0 X 17.0

‘54T’ mark is punched on the crown for identification.

Above features make USHA ‘Swift/ DZire (2020 onwards)’ piston set unique, produced to give better performance & longer life.



Technical Product News is an exclusive update of product & information from  
Shriram Pistons & Rings Ltd., 3rd Floor, Himalaya House, 23, Kasturba Gandhi Marg, New Delhi-110001  
Tel: 011-46451100, 23315941, Email: [tss@shrirampistons.com](mailto:tss@shrirampistons.com), Website: [www.shrirampistons.com](http://www.shrirampistons.com)